

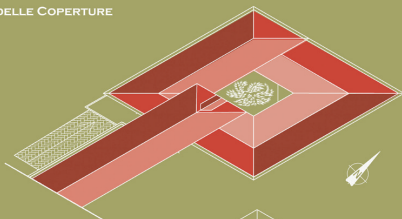

- PIANO DELLE COPERTURE

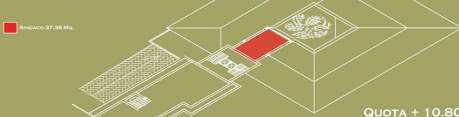

- PIANO TERZO



QUOTA + 10.80

- PIANO SECONDO / COPERTURE

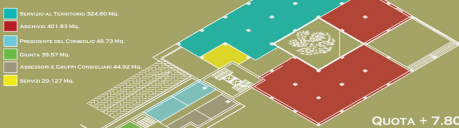

QUOTA + 7.80

- PIANO PRIMO

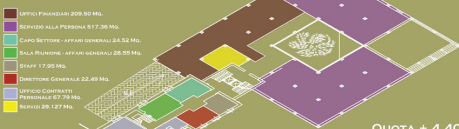

QUOTA + 4.40

- PIANO TERRA

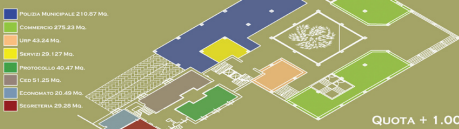

QUOTA + 1.00

- PIANO INTERRATO

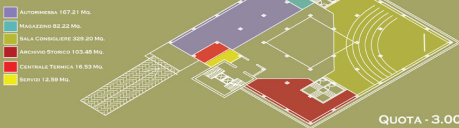

QUOTA - 3.00

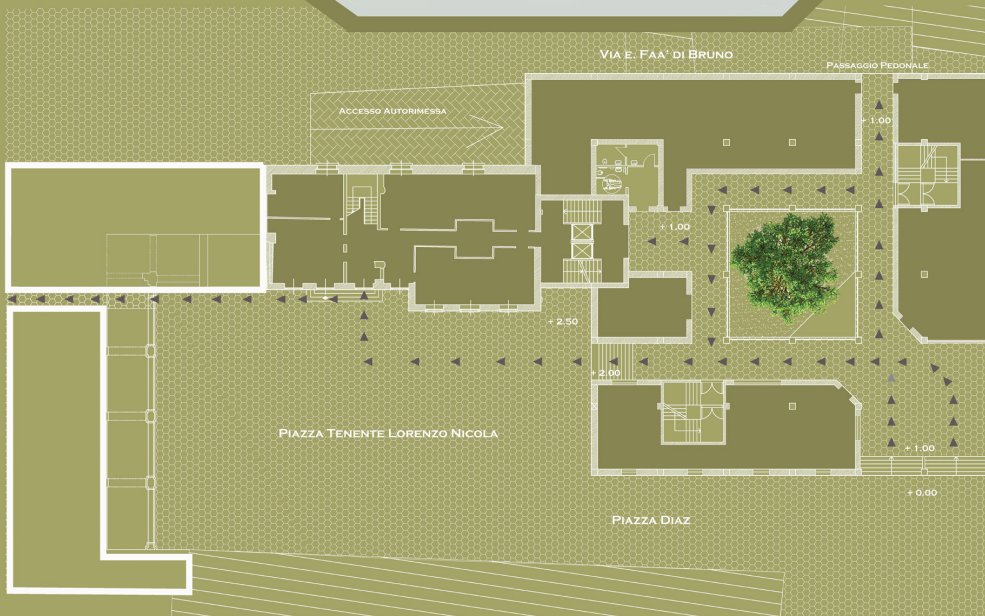

- PLANIMETRIA DEL PIANO TERRA DELL'INTERVENTO NEL CENTRO STORICO, SCALA 1:200
IN MEDIO STAT VIRTUS



- PROSPETTO LONGITUDINALE DELL'INTERVENTO NEL CENTRO STORICO

- PLANIMETRIE DELL'INTERVENTO DEL PALAZZO COMUNALE NEL CENTRO STORICO, SCALA 1:400



- FOTOINSERIMENTI DELL'INTERVENTO ALL'INTERNO DEL CENTRO STORICO



- VISUALI INTERNE DIURNE E NOTTURNE